



## Docklands, VIC

2401/90 Lorimer Street

**3** BED **2** BATH **2** CAR 

### Yarra's Edge Tower 5 Oasis

A spectacular Yarra's Edge apartment delivering 204sqm of modern living + 17sqm of balcony (approx). Desirable northerly aspect with unforgettable views of the CBD, Yarra River, and Port Phillip Bay. This 3 bedroom, 2.5 bathroom, 2 car space residence with expansive storage is Docklands luxury at its very finest.

- ? Spectacular views from floor-to-ceiling windows in lounge and dining
- ? Covered entertainer's balcony for drinks and fireworks viewing.
- ? Elegant kitchen boasts premium stone and stainless steel appliances
- ? Huge master bedroom with BIR and immaculate ensuite with bath
- ? Two additional bedrooms with terrific storage
- ? Stylish central bathroom
- ? Separate powder room

**\$2,050,000 - \$2,150,000**

**Council Rates:** \$3,000/year (approx)

**View:** Fri, 1 Nov 2024 @4:40 pm - 5:10 pm

**Contact:** Andrew Chen  
03 9645 1199  
0490 816 861  
Joe Qiao  
03 9645 1199  
0408 288 542

**Type:** Apartment  
<https://www.resbymirvac.com>

# Floor Plan

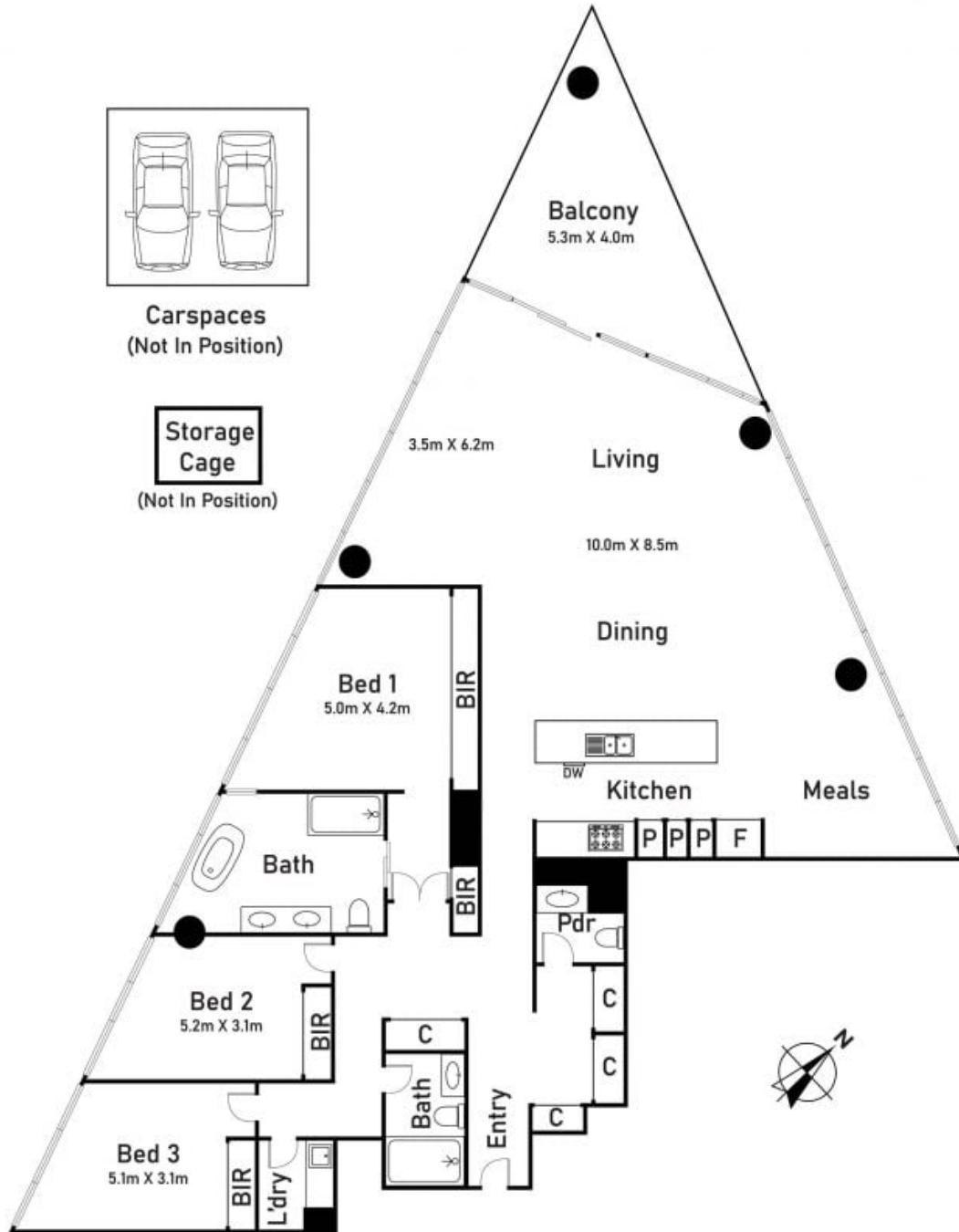

## 2401/90 Lorimer Street, Docklands

Plans shown are only indicative of layout. Dimensions are approximate and for illustrative purposes only

**Docklands, VIC**  
2401/90 Lorimer Street