



Glebe, NSW

308/2 Scotsman Street

1
BATH



Over-sized Studio Apartment in Harold Park!

Welcome to Harold Park, Glebe's Secret Backyard.

In the charming enclave of Harold Park, you'll discover a picturesque parkside setting, just a leisurely stroll from Glebe Foreshore. Merely steps away, The Tramsheds retail precinct beckons, boasting delightful cafes, a boutique grocery store, renowned restaurants, and even a convenient medical centre. Plus, enjoy close proximity to the light rail, schools, and the city, all just a short distance away, ensuring convenience and connectivity at your fingertips.

This 50sqm, level 3 Studio Apartment offers;

- Modern kitchen with stone benchtop and built-in appliances

\$690 per week

Contact: Naz Sabzpouri
02 8588 8888
0401 545 440

Type: Studio

Date Available: 29/11/2024

Bond: \$2760

<https://www.resbymirvac.com>

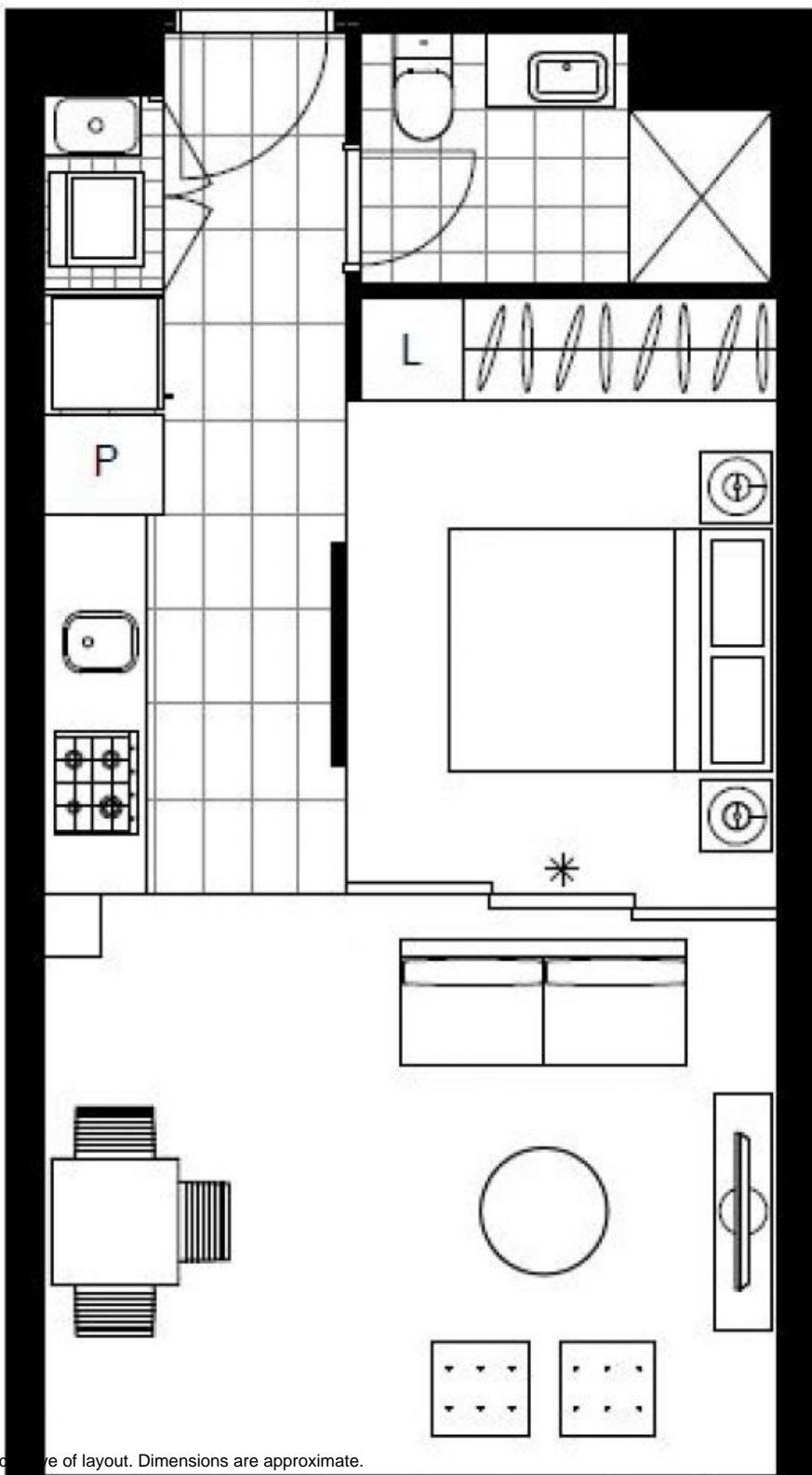

Plans shown are only indicative of layout. Dimensions are approximate.

Glebe, NSW
308/2 Scotsman Street

