



Docklands, VIC
310/103 South Wharf Drive

1 BED **1** BATH **1** CAR



North Facing Voyager Oasis
Premium Waterfront 1bedroom apartment with a secured carpark in Voyager at Yarra's Edge!
Located within Wharf's Entrance at the Yarra's Edge which forms part of Melbourne's Docklands, the site is orientated to the North East with views across the Yarra River to the Melbourne CBD.

People who is looking for a contemporary luxury lifestyle will not miss out the great apartments in Voyager! The appearance of the building is sleek and stylish with floor-to-ceiling glass windows that facing amazing city views and northern aspect overseeing Yarra's Edge Marina. Generous light-filled interiors and seamless indoor/outdoor spaces give the residents premium living experience.

\$515,000 - \$535,000
Council Rates: \$1,200/year (approx)
Contact: Andrew Chen
03 9645 1199
0490 816 861
Joe Qiao
03 9645 1199
0408 288 542
Type: Apartment
<https://www.resbymirvac.com>



LEVEL 3

APT 3.10

LOCATION PLAN

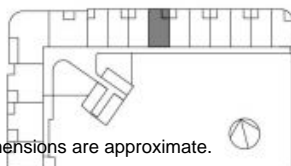

PODIUM
1 BEDROOM APARTMENT

Internal Area	54 m ²
Balcony Area	4 m ²
Total Area	58 m ²

Area subject to final survey, area includes balcony and/or terrace where applicable. It excludes parking and external storage areas.

IMPORTANT NOTICE

Please note that this floor plan was produced prior to completion of Construction. The information contained herein is believed to be correct but is not guaranteed. Dimensions and areas are approximate and areas are calculated in accordance with the Property Council of Australia Method of Measurement. Floor plans do not show additional features within each lot such as hot water systems, service yards, letterboxes and side and rear retaining walls. Purchaser option noted on floor plans is located on some lots only and is available at purchaser cost only at time of sale. Changes will undoubtedly be made during development and subject to change without notice in accordance with the provisions of the contract for sale. Special condition 10 of the contract for sale includes further information in relation to the site of the lot to be transferred. The fixtures and fittings depicted are not included with any sale and furnishings should not be taken to indicate the final position of power points, TV connection points and the like. Prospective purchasers must refer to the contract for sale for the list of inclusions. All graphics, including the layout, balustrades, planting, louvers and sun shading devices, are intended as a guide only and are not to be relied on as representative of the final product. Balustrades necessary for services are not depicted.

06/11/2015 [A]

Plans shown are only indicative of layout. Dimensions are approximate.

Docklands, VIC
310/103 South Wharf Drive