



## Glebe, NSW

509/2 Scotsman Street

**1**  
BED

**1**  
BATH



### Bright & Modern Open-Plan Apartment in Mirvac's Harold Park

Welcome to Harold Park, Glebe's Secret Backyard.

Here in Harold Park you will find yourself in an idyllic parkside location, with only a short walk to Glebe Foreshore. Just meters away, The Tramsheds retail precinct resides featuring cafes, a grocery store, restaurants and a medical centre.

This 5th floor open-plan apartment features:

- Open-plan bedroom with sliding privacy screens and generous built-in wardrobes
- Well appointed living and dining area, flowing onto spacious balcony

**\$700 per week | Deposit Taken**

**Contact:** Naz Sabzpour  
02 8588 8888  
0401 545 440

**Type:** Apartment

**Date Available:** 06/11/2024

**Bond:** \$2800

**<https://www.resbymirvac.com>**

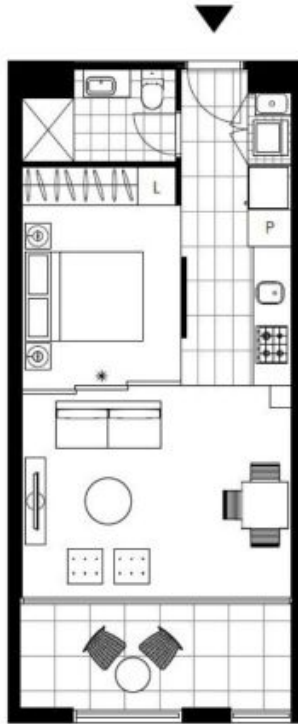

Please note that this floor plan is a guide only  
The information contained herein is not guaranteed.  
Dimensions are approximate.  
Prospective renters must rely on their own enquiries.

509/2 Scotsman St, Glebe



Plans shown are only indicative of layout. Dimensions are approximate.

**Glebe, NSW**  
509/2 Scotsman Street