



## Docklands, VIC

1705/103 South Wharf Drive

**2** BED **2** BATH **2** CAR 

### Elegant 2 bedroom apartment in Voyager building!

Welcome to Yarra's Edge, Docklands' most prestigious riverside community.

A part of the tallest, newest and most prestigious building in the Yarra's Edge precinct, this Mirvac-built Voyager apartment is set to impress. Embracing a sleek and stylish aesthetic, it has been designed with an emphasis on generous light-filled interiors and seamless open plan indoor/outdoor entertaining.

Apartment features:

- Spacious bedrooms with generous/floor-to-ceiling built-in wardrobes
- Open-plan living and dining area, with access to balcony/ideal for entertaining

**\$900 per week**

**Contact:** Emily Gray  
03 9645 1199  
0408527174  
Aleisha Clark  
03 9645 1199  
0491174507

**Type:** Apartment

**Date Available:** 29/10/2024

<https://www.resbymirvac.com>

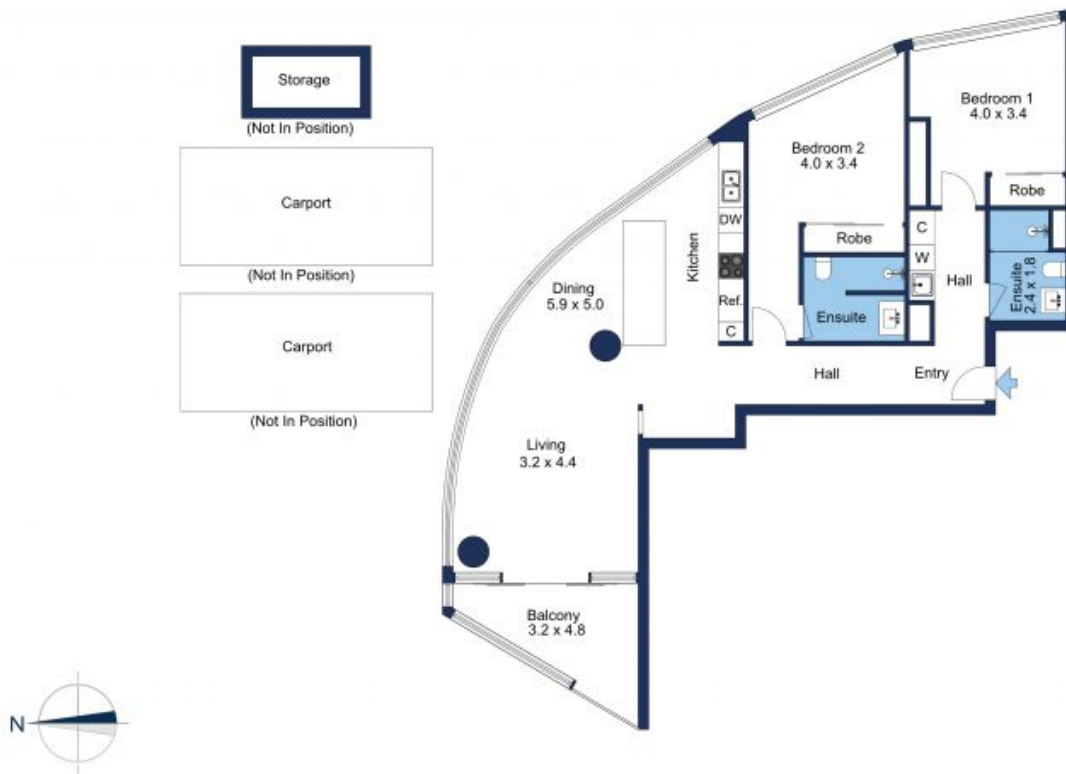

The floor plan is not to scale; measurements are indicative and in metres. Exterior elements are not in position.  
 Plans should not be relied on. Interested parties should make and rely on their own enquiries.

Plans shown are only indicative of layout. Dimensions are approximate.

**Docklands, VIC**  
 1705/103 South Wharf Drive