



**Glebe, NSW**  
601/170 Ross Street

**2** **2** **1**  
BED BATH CAR



### Oversized North-Facing 2-Bedroom Apartment in Vance

Welcome to Harold Park!

Here in Harold Park you will find yourself in an idyllic parkside location, with only a short walk to Glebe Foreshore. Just meters away, The Tramsheds retail precinct resides featuring cafes, a grocery store, restaurants and a medical centre.

This 105sqm, 5th floor Apartment has to offer:

- Large bedrooms with built-in wardrobes
- Sleek bathrooms, bath in ensuite
- Spacious open-plan living and dining leading to the North-facing balcony

**\$1,000 per week | Parking Included!**

**Contact:** Naz Sabzpouri  
02 8588 8888  
0401 545 440

**Type:** Apartment

**Date Available:** 05/09/2024

**Bond:** \$4000

<https://www.resbymirvac.com>

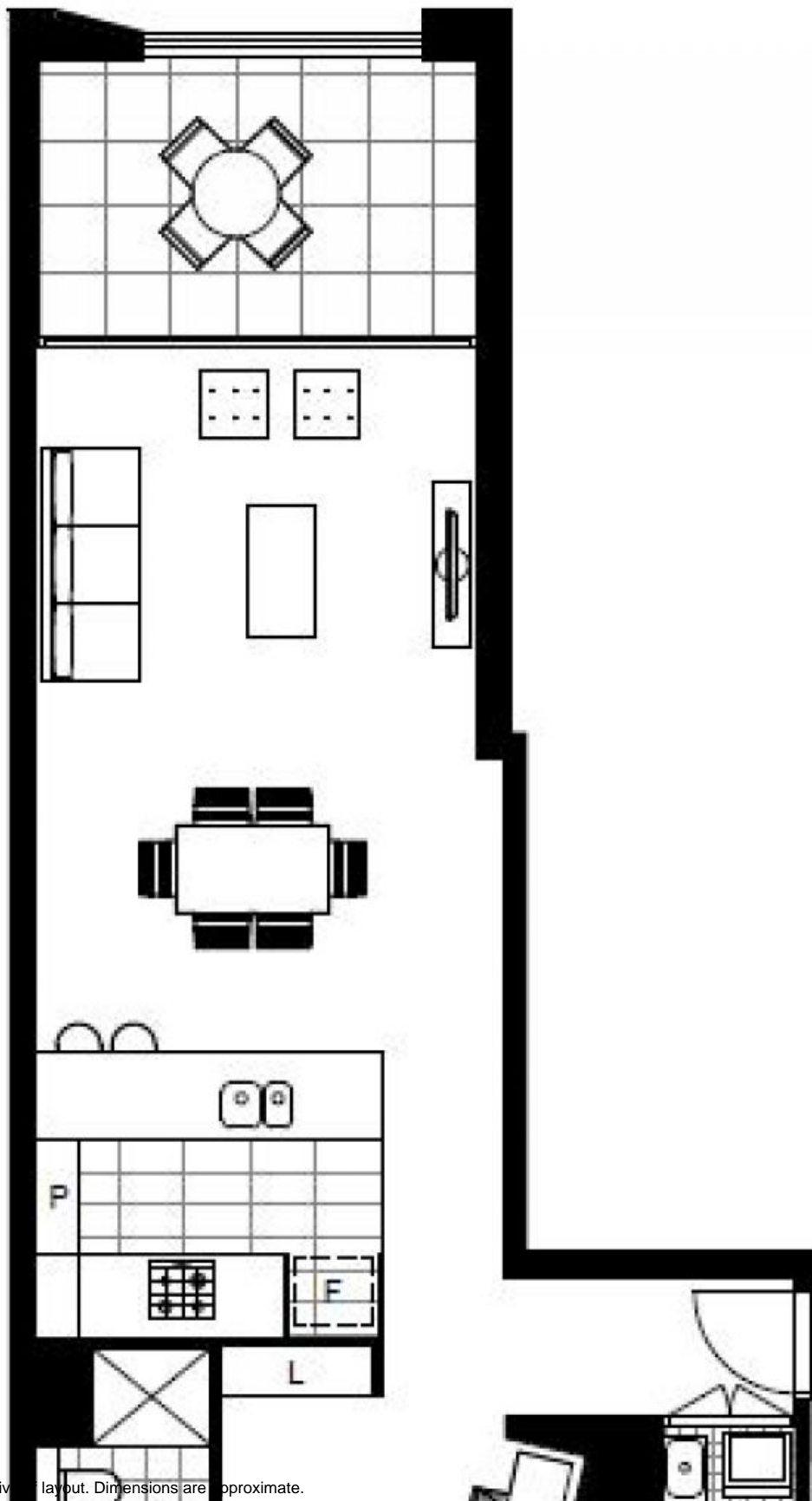

Plans shown are only indicative of layout. Dimensions are approximate.

**Glebe, NSW**  
601/170 Ross Street