



Docklands, VIC
905/103 South Wharf Drive

2 BED
2 BATH
2 CAR

A new standard in cosmopolitan lifestyle living
It indulges the senses at every turn with a wonderful sense of space, sumptuously appointed interiors and superb river and city views that transform into a dazzling backdrop in the evening. As comfy as it is to stay in, it's the many attractions that await just outside your door that make this home so special.

Step out and stroll to manicured Wharfs Landing Park and keep in shape by walking along the waterfront or taking advantage of the complementary Wharf Club membership.

- This expansive 2Bedroom waterfront apartment features:
- Organic living and dining zone flowing to riverfront balcony
 - Entertainers kitchen with large island bench, ample storage

\$830 per week
Contact: Emily Gray
 03 9645 1199
 0408 527 174
 Aleiasha Clark
 03 9645 1199
 0491 174 507
Type: Apartment
Date Available: 23/08/2024
<https://www.resbymirvac.com>

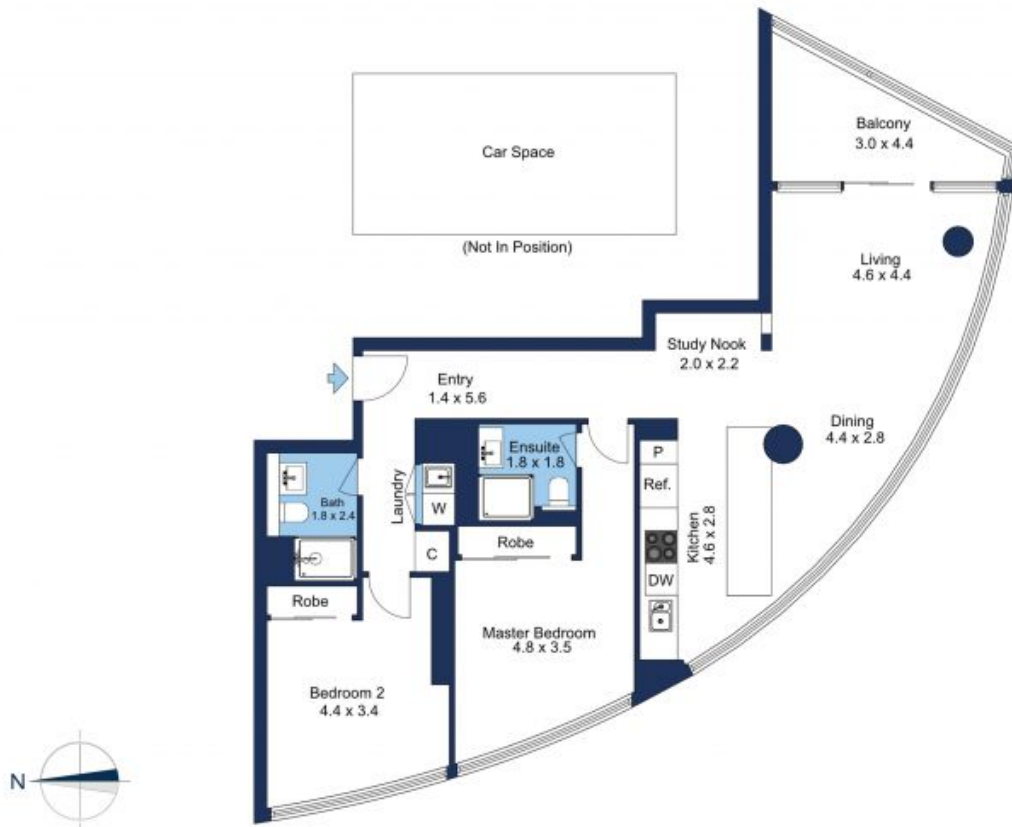

The floor plan is not to scale; measurements are indicative and in metres. Exterior elements are not in position. Plans should not be relied on. Interested parties should make and rely on their own enquiries.

Plans shown are only indicative of layout. Dimensions are approximate.

Docklands, VIC
905/103 South Wharf Drive