



Glebe, NSW

307/2 Scotsman Street

1
BED

1
BATH



Oversized 1 Bedroom Apartment with Ledy Outlook in Harold Park, Glebe

Welcome to Harold Park, Glebe's Secret Backyard.

Here in Harold Park you will find yourself in an idyllic parkside location, with only a short walk to Glebe Foreshore. Just meters away, The Tramsheds retail precinct resides featuring cafes, a grocery store, restaurants and a medical centre.

This 66sqm, 3rd floor apartment features:

- Large bedroom with generous built-in wardrobe
- Open-plan living and dining area, leading to the balcony
- Contemporary kitchen with stone benchtop and Miele appliances

\$760 per week

Contact: Naz Sabzpour
02 8588 8888
0401 545 440

Type: Apartment

Date Available: 23/07/2024

<https://www.resbymirvac.com>

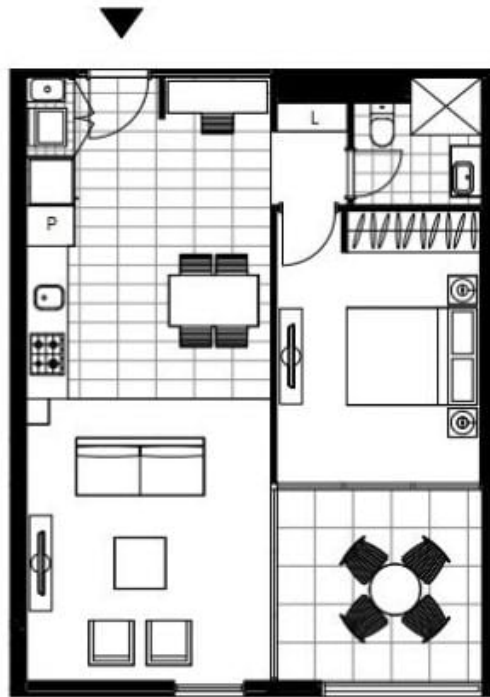

LEVEL 3,5

Plans shown are only indicative of layout. Dimensions are approximate.

Glebe, NSW
307/2 Scotsman Street