

Docklands, VIC
2602/50 Lorimer Street

3 BED **2** BATH **2** CAR 

Northeast-Facing 'Yarra's Edge' sparkler
Presiding over the Yarra River and the glistening skyline of Melbourne's CBD, this apartment provides an urban sanctuary for those who value a fast-paced city lifestyle. The sweeping balcony that runs the full length of the apartment creates an exceptional indoor/outdoor design for every living space and bedroom with sparkling views to match. Timber floors are set against crisp white walls while sumptuous finishes and inclusions appoint every space. Set in a waterfront community like no other, keep in shape thanks to a complementary RekDek membership and enjoy local parks, walking tracks, cafes and vibrant nightlife.

- ? Open plan kitchen and wonderfully roomy living/dining area
- ? Stone bench tops, gas stainless steel appliances, dishwasher
- ? Generous bedrooms with built-in robes and balcony access

\$1,290,000 - \$1,340,000
Council Rates: \$2,300/year (approx)
View: Wed, 3 Jul 2024 @12:00 pm - 12:20 pm
Sat, 6 Jul 2024 @1:30 pm - 1:50 pm
Contact: Andrew Chen
03 9645 1199
0490 816 861
Joe Qiao
03 9645 1199
0408 288 542
Type: Apartment
<https://www.resbymirvac.com>

2602/50 LORIMER STREET, DOCKLANDS

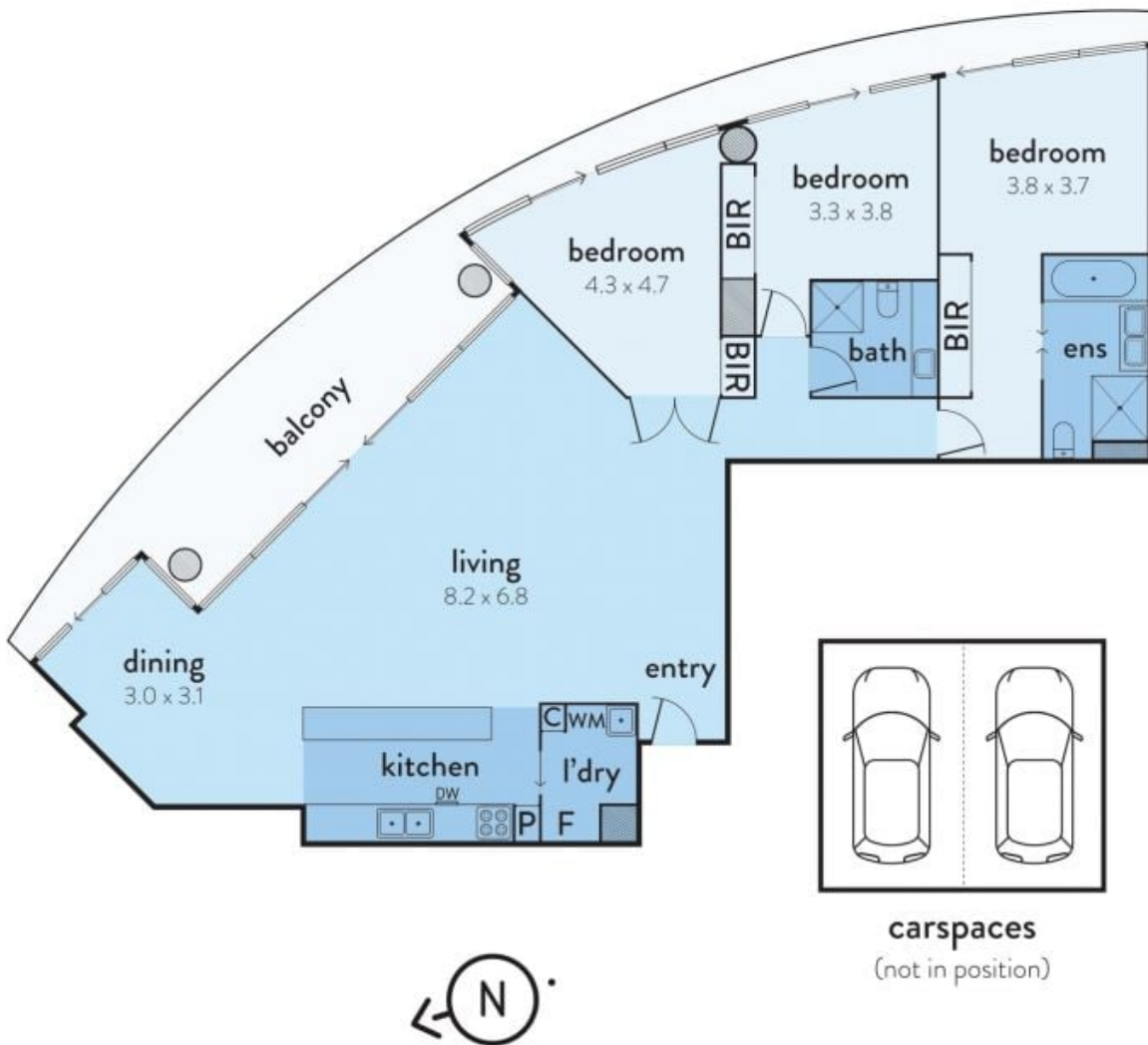

 **real estate services**
by mirvac

Plans shown are only indicative of layout. Dimensions are approximate.

The above plan is an artist's impression only, it includes elements that are for display purposes and may not be to scale. Dimensions are approximate and every care has been taken to verify the accuracy of details.

Docklands, VIC
2602/50 Lorimer Street