



Docklands, VIC

3505/103 South Wharf Drive

2 BED **1** BATH **1** CAR 

Sunset vistas from Mirvac-built Voyager Tower

Need a break from the hustle and bustle? Welcome to Voyager,

A revelation of style, quality and lifestyle excellence unfolds with perfect poise in this luxury 'Voyager' apartment in the waterfront Mirvac-developed Yarra's Edge precinct.

Step out to waterfront reserves, a children's playground, foreshore walks and the Wharf Club (free for residents). There are lovely local shops, cafes and restaurants to choose from and all the excitement of Southbank and the CBD within walking distance or a brief commute. It's moments to Port Melbourne and serene Port Philip Bay.

Apartment Features:

\$730 per week

Contact: Aleiasha Clark
03 9645 1199
0491 174 507

Type: Apartment

Date Available: 08/07/2024

<https://www.resbymirvac.com>

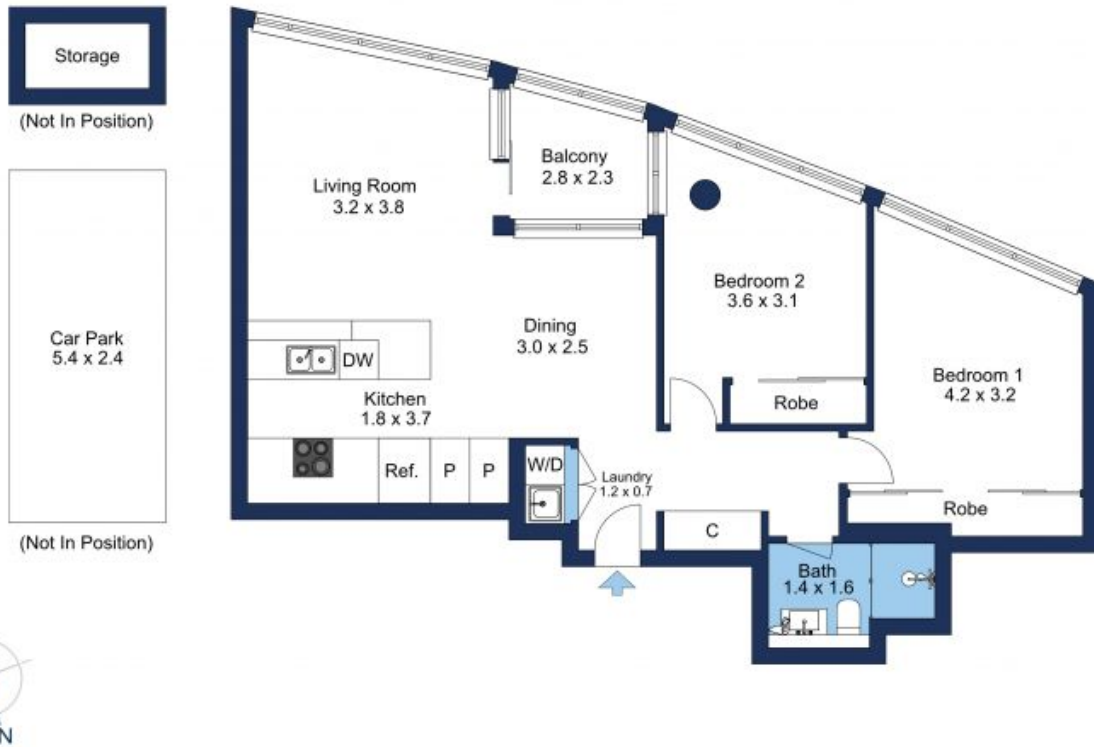

The floor plan is not to scale; measurements are indicative and in metres. Exterior elements are not in position. Plans should not be relied on. Interested parties should make and rely on their own enquiries.

Plans shown are only indicative of layout. Dimensions are approximate.

Docklands, VIC
3505/103 South Wharf Drive