

Glebe, NSW

508/2 Scotsman Street

1
BATH



Stylish Open-Plan Apartment in Mirvac's Harold Park

Welcome to Harold Park, Glebe's Secret Backyard.

Here in Harold Park you will find yourself in an idyllic parkside location, with only a short walk to Glebe Foreshore. Just meters away, The Tramsheds retail precinct resides featuring cafes, a grocery store, restaurants and a medical centre.

This 5th floor Open-Plan Apartment features:

- Bed area with sliding dividers, separating living and sleeping
- Generous floor to ceiling built-in wardrobe
- Open-plan living and dining area flowing onto balcony
- Modern kitchen with stone benchtops and Miele appliances

\$700 per week

View: Tue, 2 Jul 2024 @2:15 pm - 2:30 pm

Contact: Naz Sabzpouri

02 8588 8888

0401 545 440

Type: Apartment

Date Available: 28/05/2023

<https://www.resbymirvac.com>

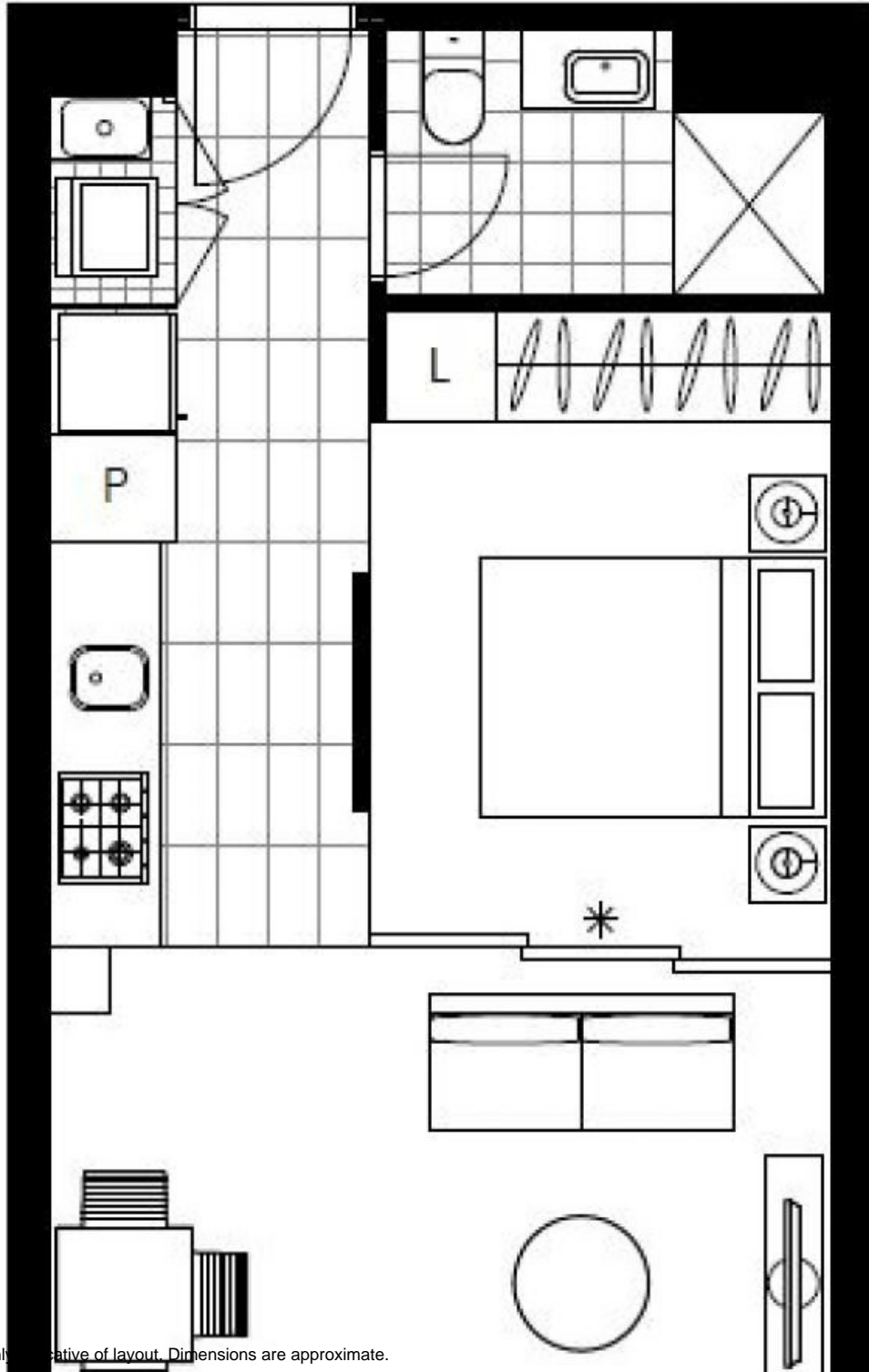

Plans shown are only representative of layout. Dimensions are approximate.

Glebe, NSW
508/2 Scotsman Street

