



Docklands, VIC

2508/103 South Wharf Drive

2 BED **1** BATH **1** CAR 

All the glory of waterfront living so close to the CBD in 'Voyager' tower

A revelation of style, quality and lifestyle excellence unfolds with perfect poise in this luxury 'Voyager' apartment in the waterfront Mirvac-developed Yarra's Edge precinct. It offers space, elegance and views without compromise.

A home that will delight executive couples, young families and vibrant downsizers alike, it's community-oriented and promotes an active and social lifestyle.

Apartment Features:

- Expansive kitchen with island bench and ample storage
- Stone bench tops, gas stainless steel appliances

\$750 per week

Contact: Aleiasha Clark
03 9645 1199
0491 174 507

Type: Apartment

Date Available: 01/02/2024

<https://www.resbymirvac.com>

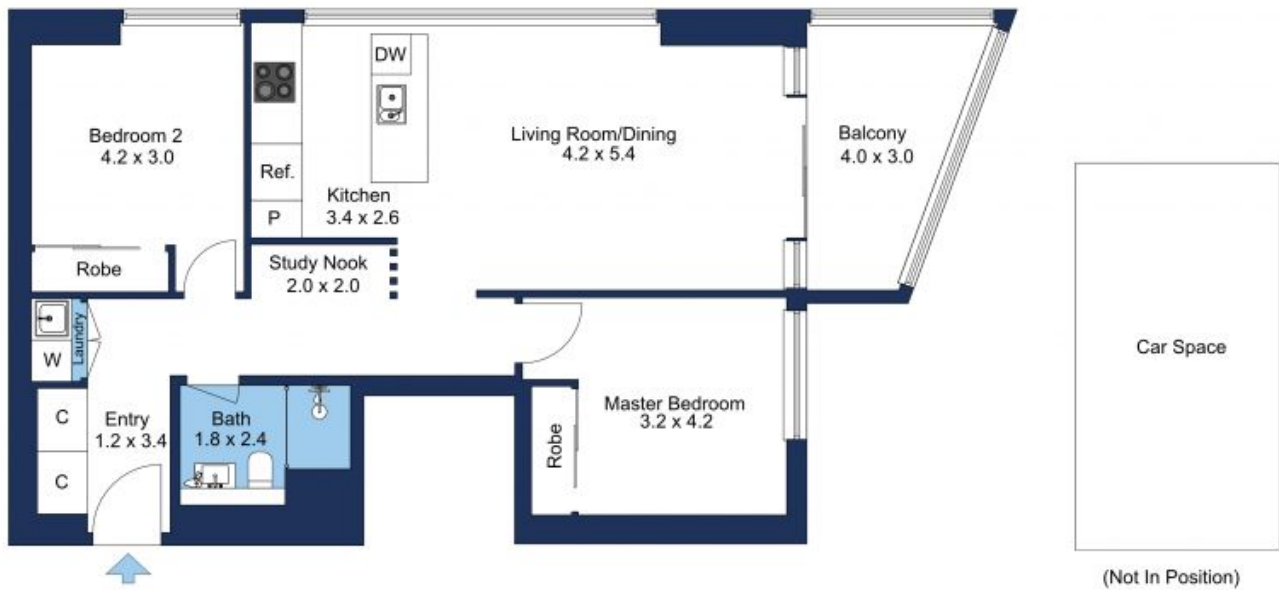

The floor plan is not to scale; measurements are indicative and in metres. Exterior elements are not in position. Plans should not be relied on. Interested parties should make and rely on their own enquiries.

Plans shown are only indicative of layout. Dimensions are approximate.

Docklands, VIC
2508/103 South Wharf Drive